

# PLAIN WASHERS

**Table 1A Dimensions of Preferred Sizes of Type A Plain Washers**

Nominal Washer Size	A			B			C			
	Inside Diameter			Outside Diameter			Thickness			
	Basic	Tolerance		Basic	Tolerance		Basic	Max	Min	
		Plus	Minus		Plus	Minus				
— —	0.078	0.000	0.005	0.188	0.000	0.005	0.020	0.025	0.016	
— —	0.094	0.000	0.005	0.250	0.000	0.005	0.020	0.025	0.016	
— —	0.125	0.008	0.005	0.312	0.008	0.005	0.032	0.040	0.025	
No. 6 0.138	0.156	0.008	0.005	0.375	0.015	0.005	0.049	0.065	0.036	
8 0.164	0.188	0.008	0.005	0.438	0.015	0.005	0.049	0.065	0.036	
10 0.190	0.219	0.008	0.005	0.500	0.015	0.005	0.049	0.065	0.036	
3/16 0.188	0.250	0.015	0.005	0.562	0.015	0.005	0.049	0.065	0.036	
12 0.216	0.250	0.015	0.005	0.562	0.015	0.005	0.065	0.080	0.051	
1/4 0.250 N	0.281	0.015	0.005	0.625	0.015	0.005	0.065	0.080	0.051	
1/4 0.250 W	0.312	0.015	0.005	0.734	0.015	0.007	0.065	0.080	0.051	
5/16 0.312 N	0.344	0.015	0.005	0.688	0.015	0.007	0.065	0.080	0.051	
5/16 0.312 W	0.375	0.015	0.005	0.875	0.030	0.007	0.083	0.104	0.064	
3/8 0.375 N	0.406	0.015	0.005	0.812	0.015	0.007	0.065	0.080	0.051	
3/8 0.375 W	0.438	0.015	0.005	1.000	0.030	0.007	0.083	0.104	0.064	
7/16 0.438 N	0.469	0.015	0.005	0.922	0.015	0.007	0.065	0.080	0.051	
7/16 0.438 W	0.500	0.015	0.005	1.250	0.030	0.007	0.083	0.104	0.064	
1/2 0.500 N	0.531	0.015	0.005	1.062	0.030	0.007	0.095	0.121	0.074	
1/2 0.500 W	0.562	0.015	0.005	1.375	0.030	0.007	0.109	0.132	0.086	
9/16 0.562 N	0.594	0.015	0.005	1.156	0.030	0.007	0.095	0.121	0.074	
9/16 0.562 W	0.625	0.015	0.005	1.469	0.030	0.007	0.109	0.132	0.086	
5/8 0.625 N	0.656	0.030	0.007	1.312	0.030	0.007	0.095	0.121	0.074	
5/8 0.625 W	0.688	0.030	0.007	1.750	0.030	0.007	0.134	0.160	0.108	
3/4 0.750 N	0.812	0.030	0.007	1.469	0.030	0.007	0.134	0.160	0.108	
3/4 0.750 W	0.812	0.030	0.007	2.000	0.030	0.007	0.148	0.177	0.122	
7/8 0.875 N	0.938	0.030	0.007	1.750	0.030	0.007	0.134	0.160	0.108	
7/8 0.875 W	0.938	0.030	0.007	2.250	0.030	0.007	0.165	0.192	0.136	
1 1.000 N	1.062	0.030	0.007	2.000	0.030	0.007	0.134	0.160	0.108	
1 1.000 W	1.062	0.030	0.007	2.500	0.030	0.007	0.165	0.192	0.136	
1-1/8 1.125 N	1.250	0.030	0.007	2.250	0.030	0.007	0.134	0.160	0.108	
1-1/8 1.125 W	1.250	0.030	0.007	2.750	0.030	0.007	0.165	0.192	0.136	
1-1/4 1.250 N	1.375	0.030	0.007	2.500	0.030	0.007	0.165	0.192	0.136	
1-1/4 1.250 W	1.375	0.030	0.007	3.000	0.030	0.007	0.165	0.192	0.136	
1-3/8 1.375 N	1.500	0.030	0.007	2.750	0.030	0.007	0.165	0.192	0.136	
1-3/8 1.375 W	1.500	0.045	0.010	3.250	0.045	0.010	0.180	0.213	0.153	
1-1/2 1.500 N	1.625	0.030	0.007	3.000	0.030	0.007	0.165	0.192	0.136	
1-1/2 1.500 W	1.625	0.045	0.010	3.500	0.045	0.010	0.180	0.213	0.153	
1-5/8 1.625	1.750	0.045	0.010	3.750	0.045	0.010	0.180	0.213	0.153	
1-3/4 1.750	1.875	0.045	0.010	4.000	0.045	0.010	0.180	0.213	0.153	
1-7/8 1.875	2.000	0.045	0.010	4.250	0.045	0.010	0.180	0.213	0.153	
2 2.000	2.125	0.045	0.010	4.500	0.045	0.010	0.180	0.213	0.153	
2-1/4 2.250	2.375	0.045	0.010	4.750	0.045	0.010	0.220	0.248	0.193	
2-1/2 2.500	2.625	0.045	0.010	5.000	0.045	0.010	0.238	0.280	0.210	
2-3/4 2.750	2.875	0.065	0.010	5.250	0.065	0.010	0.259	0.310	0.228	
3 3.000	3.125	0.065	0.010	5.500	0.065	0.010	0.284	0.327	0.249	
See Notes 1, 2, 3, 5				4						

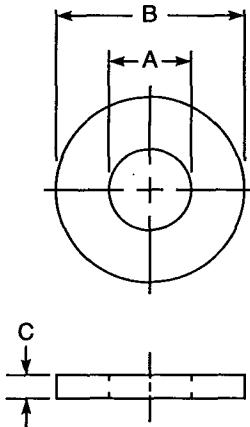

**NOTES:**

- (1) Preferred sizes are for the most part from series previously designated "Standard Plate" and "SAE." Where common sizes existed in the two series, the SAE size is designated "N" (narrow) and the Standard Plate "W" (wide). These sizes as well as all other sizes of Type A Plain Washers are to be ordered by ID, OD and thickness dimensions.
- (2) Additional selected sizes of Type A Plain Washers are shown in Table 1B.
- (3) Nominal washer sizes are intended for use with comparable nominal screw or bolt sizes.
- (4) The 0.734 in., 1.156 in. and 1.469 in. outside diameters avoid washers which could be used in coin operated devices.
- (5) See Introductory Notes, page L-1.